

1. SPECIFICATION

AK-130805-MM-1C

| ITEM | | SPECIFICATIONS | |
|------|----------------------------|------------------------------------|-----------------------------------|
| 01 | Type | Dynamic speaker | |
| 02 | Dimension | External diameter 13 mm | |
| 03 | Rated Input Power | 0.5 W | |
| 04 | Max. Input Power | 0.8 W for 1 minute | |
| 05 | Impedance | $8\Omega \pm 15\%$ at 2KHz 1V | |
| 06 | Resonance Frequency (Fo) | 1300 Hz $\pm 20\%$ at Fo, 1V | |
| 07 | Sound pressure level | 87 dB (0.5W/0.1M) ± 3 dB | at AVE 1.5K, 1.8K, 2.0K, 2.2 KHz. |
| 08 | Frequency Range | Fo – 20 K Hz | |
| 09 | Total Harmonics Distortion | Max 10 % at 1 KHz, 0.1W(0.89V rms) | |

| | | | |
|---------|---------------|----------|------|
| REV NO. | REVISION NOTE | APPROVAL | DATE |
|---------|---------------|----------|------|

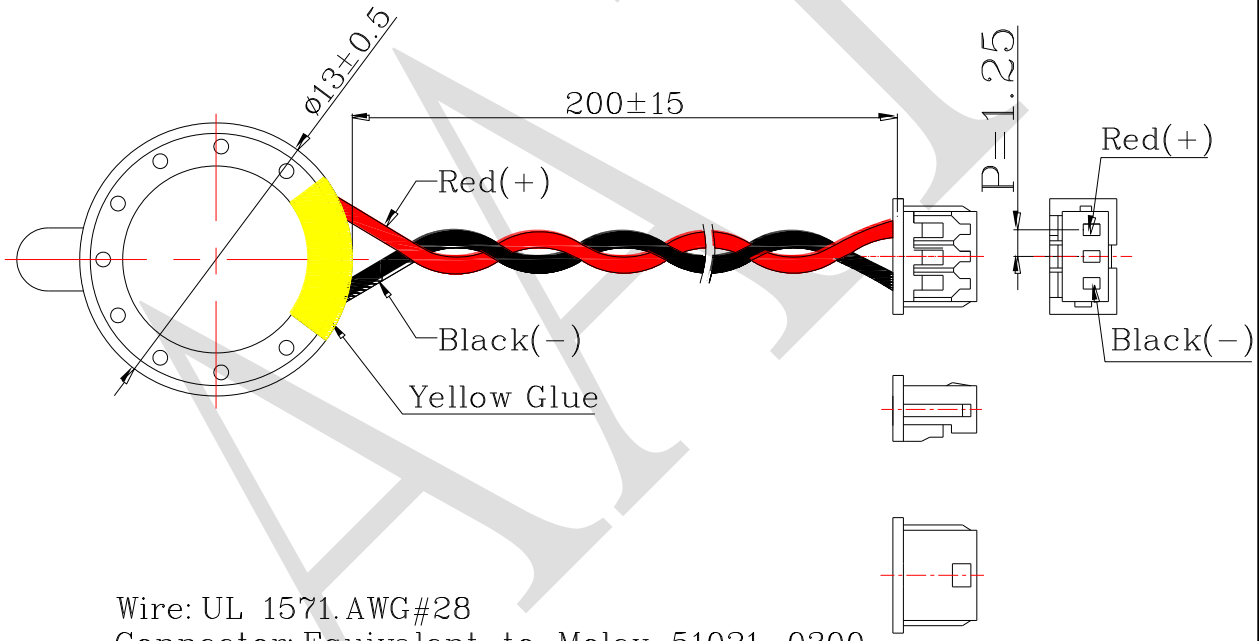
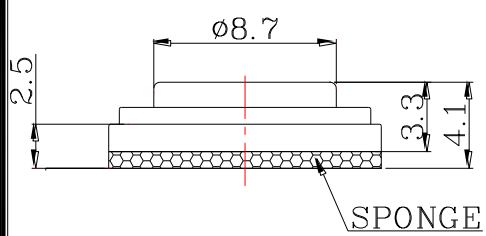
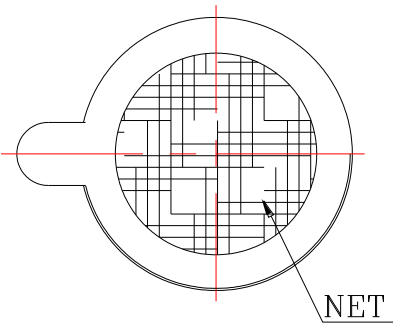

Wire: UL 1571.AWG#28
 Connector: Equivalent to Molex 51021-0300

RoHS

| | | | | | |
|---------------------------------|--|----------------------|------------|-----------------------------|------------|
| TITLE: DYNAMIC SPEAKER | | DRAWN: Zack | 2016/01/05 | SCALE: 2:1 | SHEET: 1:1 |
| PART NO. AK-130805-MM-1C | | DESIGNED: R&D OF AAT | | UNITS: mm | |
| DWG NO. CXS13041LP200-R08W0.5-D | | CHECKED: | | TOLERANCE ± 0.5 | |
| | | APPROVAL: | | UNLESS OTHERWISE SPECIFIED: | |
| REV | | MATERIAL: SPCC | | ONE PLACE DECIMAL ± *** | |
| | | | | TWO PLACE DECIMAL ± *** | |
| | | | | THREE PLACE DECIMAL ± *** | |



ADVANCED ACOUSTIC TECHNOLOGY CORPORATION

For more information, please contact AATC.

AATC